



ALLEGHENY COUNTY AIRPORT AUTHORITY

---

PITTSBURGH INTERNATIONAL AIRPORT  
ALLEGHENY COUNTY AIRPORT



AIR SERVICE UPDATE

# Connecting Pittsburgh with the World



# Service to the West Coast has increased significantly since 2022 with more flights and new destinations

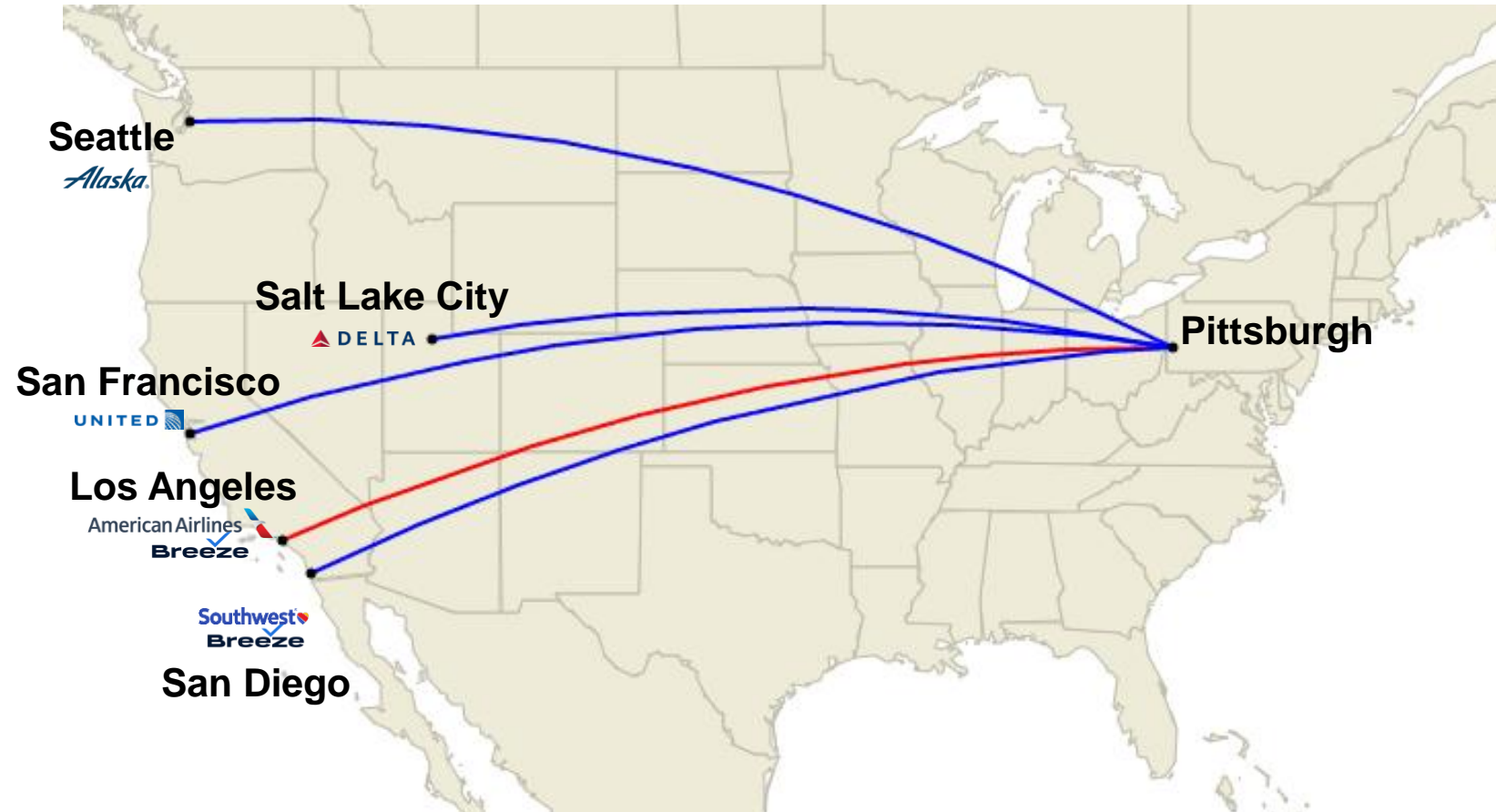

- Alaska increased Seattle service to 2x/day in June 2022
- United increased San Francisco service to 2x/day in August 2023
- Breeze (May) and Southwest (June) added San Diego in 2024
- Delta added Salt Lake City in November 2024
- **American will add Los Angeles in April 2025**

# Passenger traffic is on track for its busiest year since 2006; well above 2019 figures

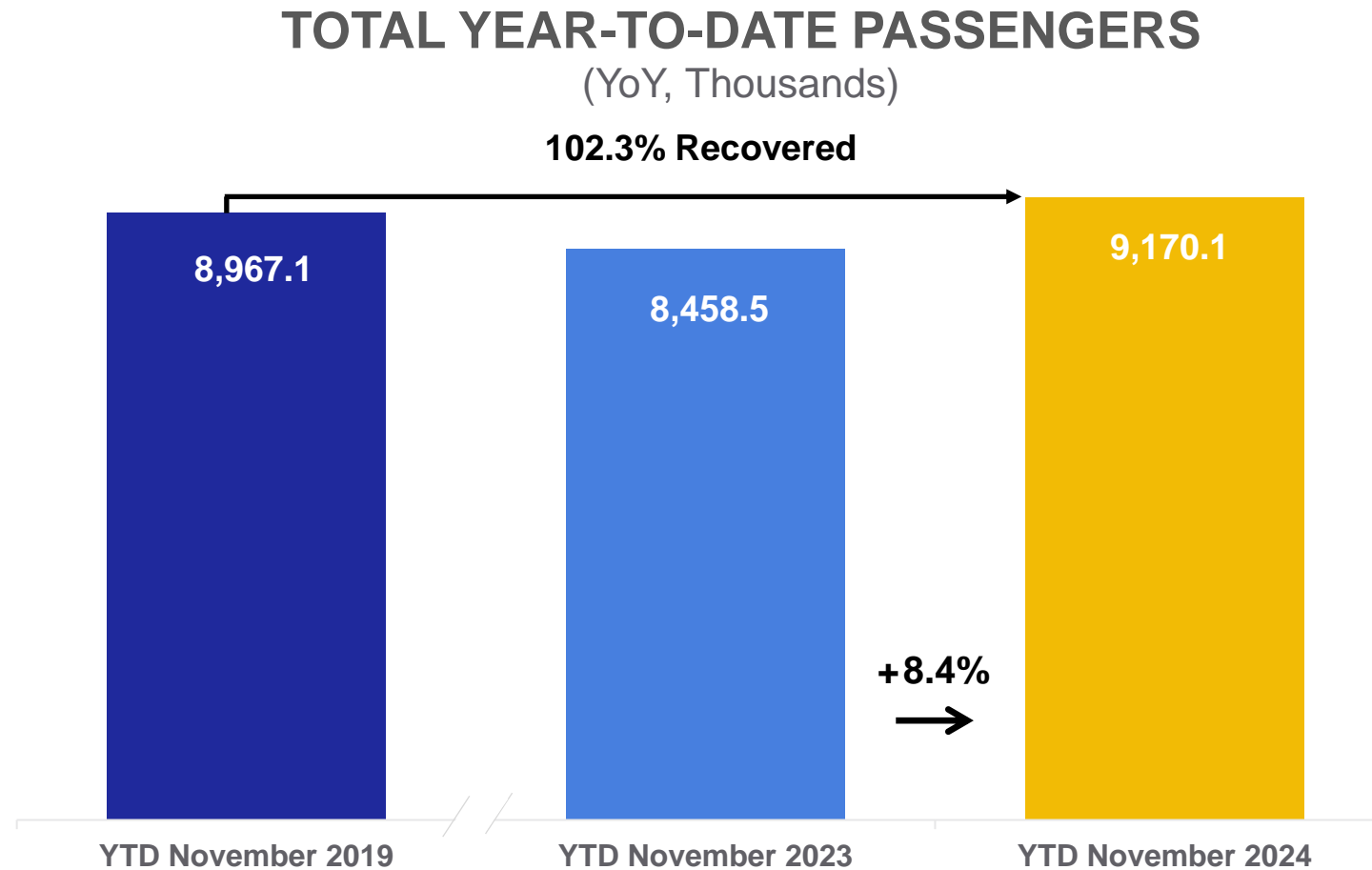

SOURCE: Allegheny County Airport Authority



# November 2024 passenger traffic saw a slight dip year-over-year; still second busiest November post-pandemic

## TOTAL NOVEMBER PASSENGERS (YoY, Thousands)

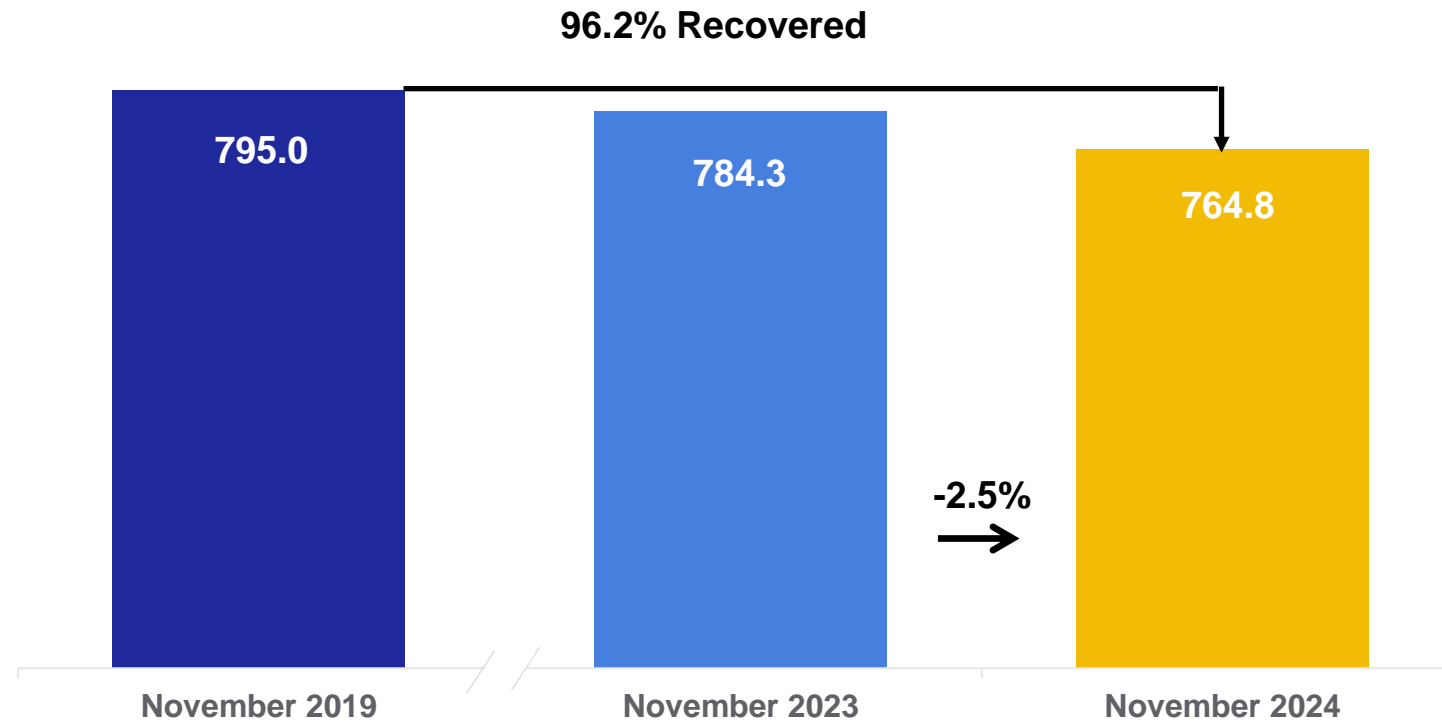

SOURCE: Allegheny County Airport Authority



# Consistent with historical trends, passenger traffic is lower when Thanksgiving falls at the end of the month

**NOV 2018 vs. NOV 2019 PASSENGERS**  
(YoY, Thousands)

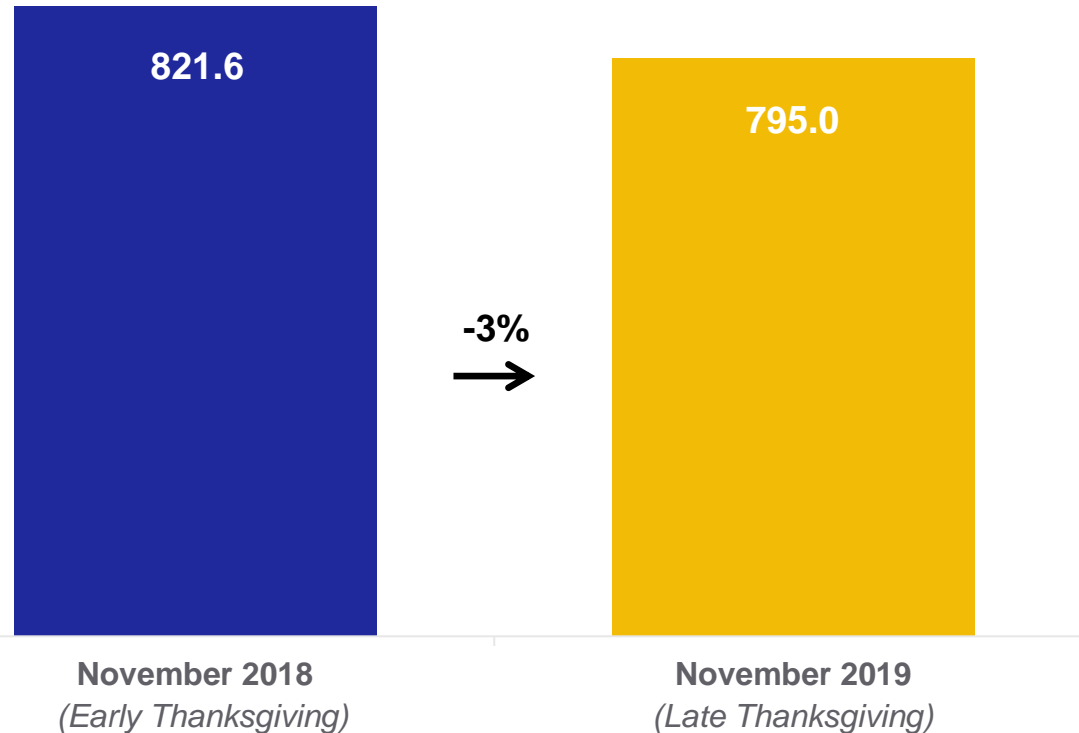

**NOV 2023 vs. NOV 2024 PASSENGERS**  
(YoY, Thousands)

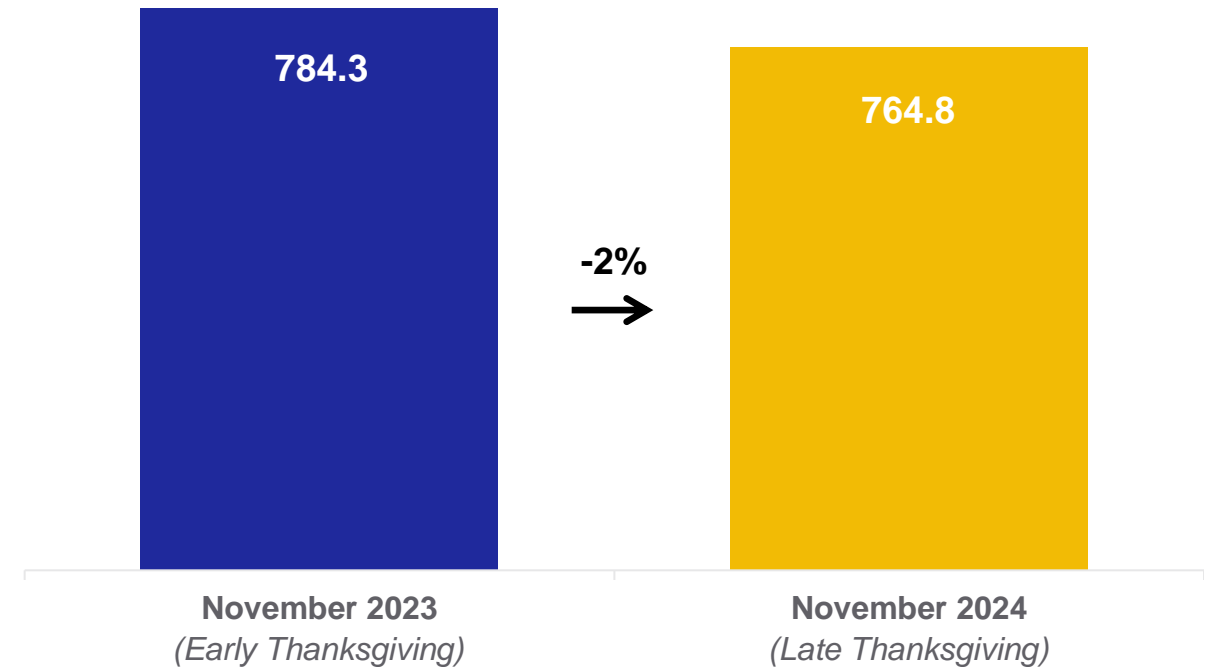

# Total capacity decreased on a year-over-year basis due to changes by low-cost carriers

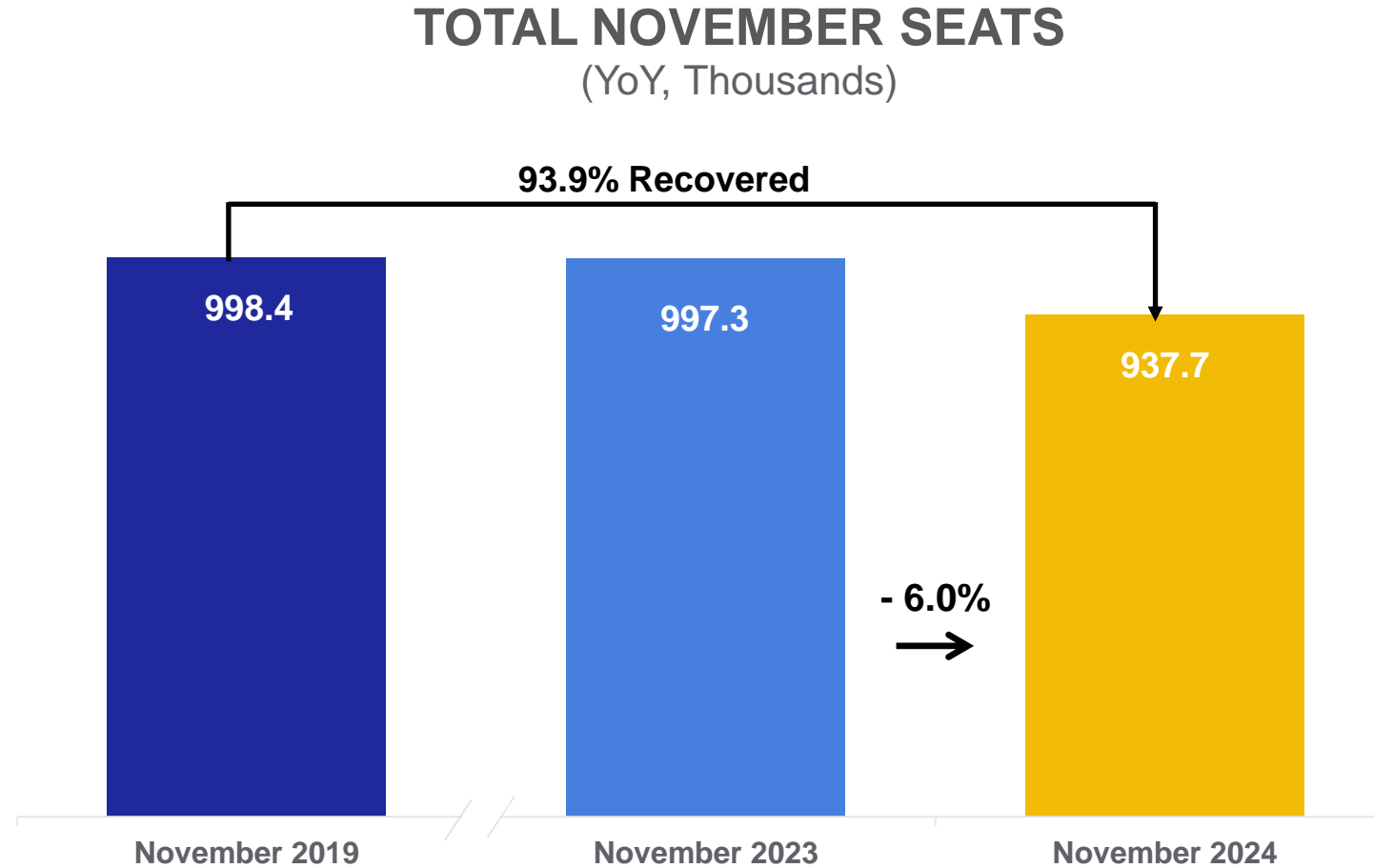

SOURCE: Cirium DiiO Mi



# Southwest regained the top spot in market share at PIT in November 2024

PITTSBURGH PASSENGER SHARE BY CARRIER  
(November 2024)

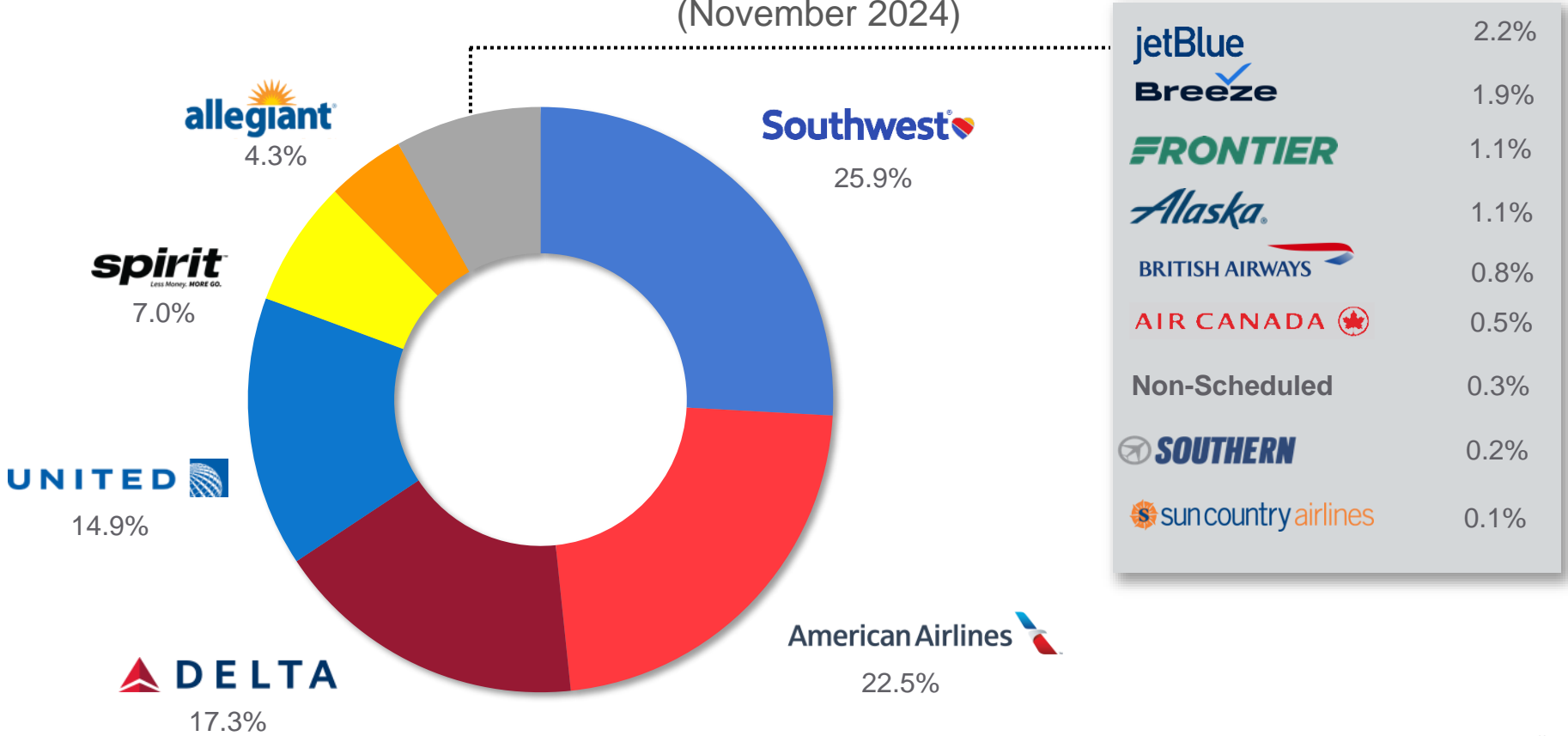

SOURCE: Allegheny County Airport Authority  
NOTE: Values are rounded



# PIT now has nonstop service to 61 destinations with 156 peak-day departures

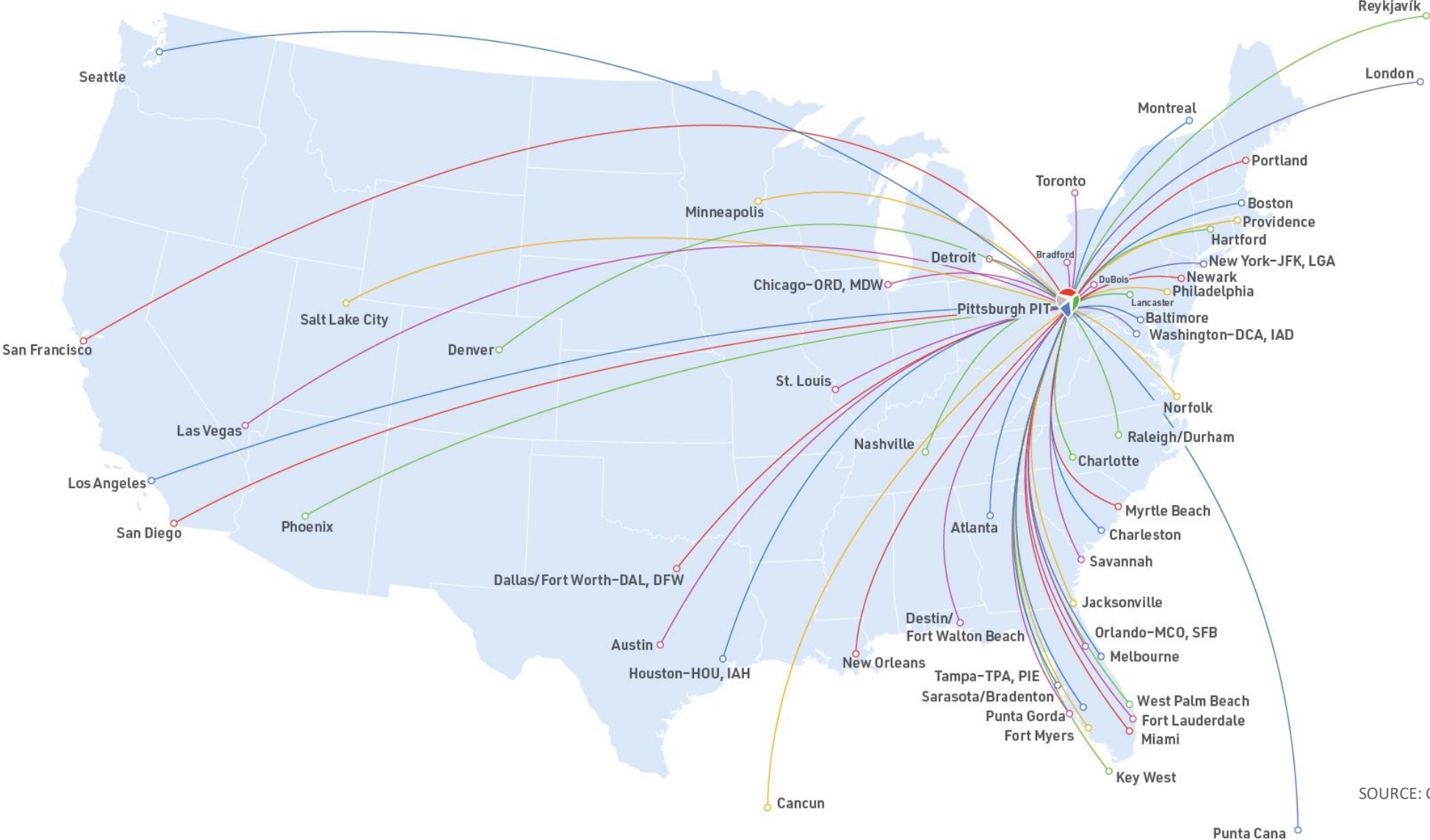

SOURCE: Cirium Innovata Schedules

THE NEW

# Pittsburgh International Airport



# Construction continues to reach significant milestones – the new PIT remains on schedule to open in 2025

Parking garage technology system installation underway

Tree column painting continues

Terrazzo flooring installation continues

Internal and external ceiling installation continues

Escalator and elevator installations continue

Interior framing and drywalling continues

Air handling unit activations ongoing





NAVIGATING A NEW PIT

# Transforming the Airport Experience



# The new PIT draws upon the region's spirit of innovation to completely transform the airport experience



We launched an approach unlike any other airport, infusing intuition into our design



# New technology and intentional design will simplify the experience and provide a sense of place

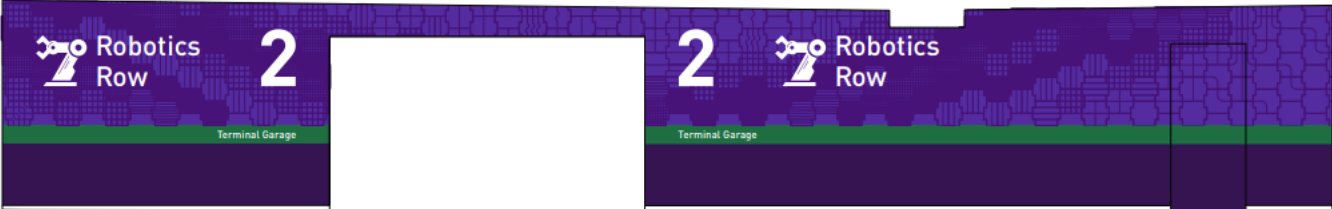
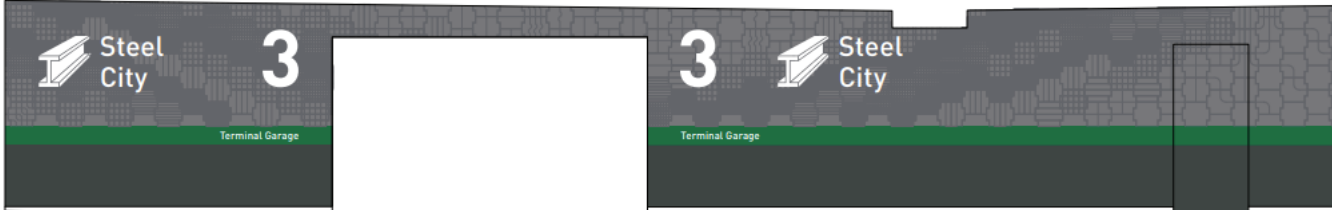
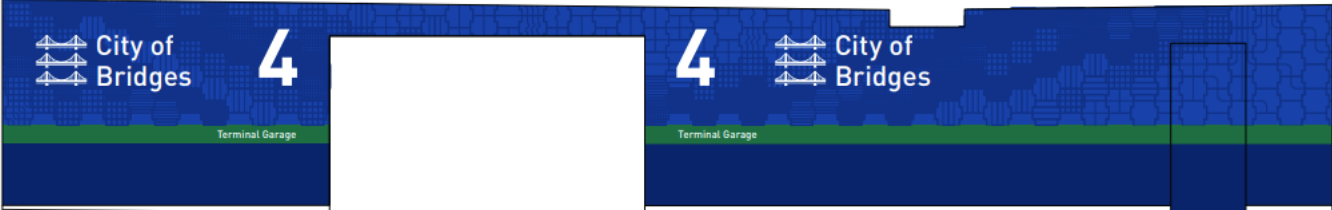
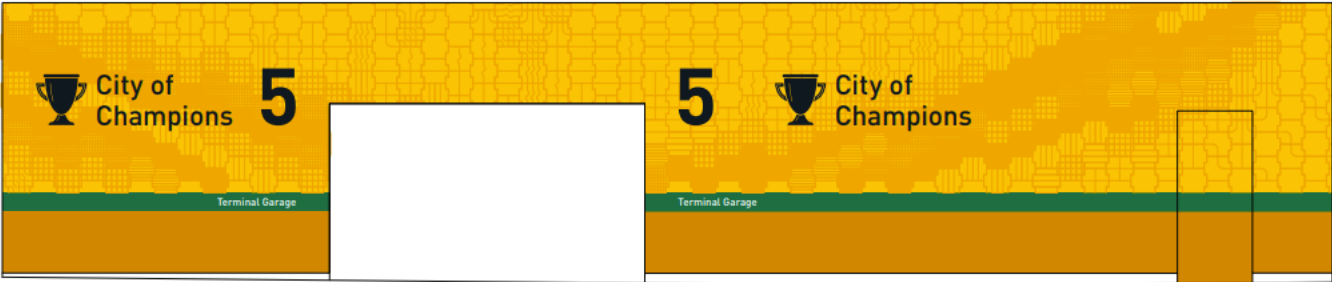

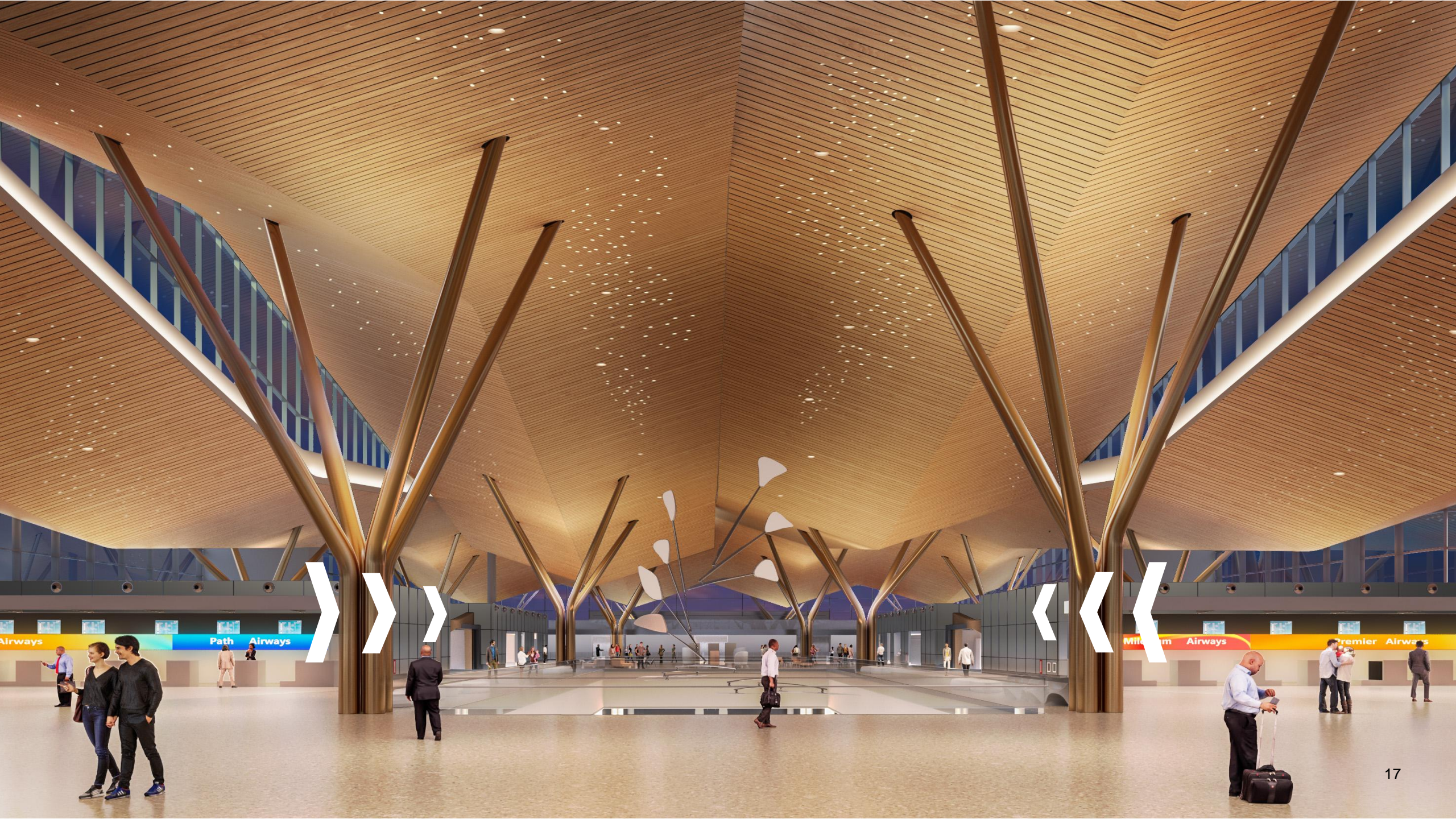

# The result is a modernized, more navigable, distinctly Pittsburgh experience





ALLEGHENY COUNTY AIRPORT AUTHORITY

---

PITTSBURGH INTERNATIONAL AIRPORT  
ALLEGHENY COUNTY AIRPORT

